



## 2023 Seminole Sound Spectacular Contest Info

**Date:** Saturday, October 7<sup>th</sup>, 2023

**Place:** Seminole High School - 8401 131st Street, Seminole, FL 33776

### **Contact Info:**

Gerard Madrinan, Band Director (727) 244-8421

Aaron Levith, Show Coordinator (321) 284-5280

### **Admission Prices:**

General Admission - \$17

Children 4 - 11 - \$13

Children under 4 - Free

Any CC payments will incur a fee

Free Parking - Parking Donations Accepted

**Show Details:** Finals only show with officer retreat. 1st, 2nd, and 3rd place caption trophies are awarded for each class. Grand Champion and the Lee Gebhardt Awards will also be given.

### **Class Sizes:**

- Exhibition (Rating Only)
- Class A - up to 45 students
- Class AA - 46-70 students
- Class AAA - 71- 101 students
- Class AAAA - 102-140 students
- Class AAAAA - 141 + students

Performers, chaperones, and staff will have access to the backside seating. Wristband required for all seating areas.

Multiple concession vendors will be available!



# 2023 Seminole Sound Spectacular Adjudication Panel

**GE Music:** Evan Rogavin

**GE Visual:** Bruce Jones

**Ensemble Music:** Steve Visnage

**Ensemble Visual:** Jack Pursiful

**Field Music:** Bill Durst

**Field Visual:** Patrick Duncan

**Percussion:** John Campese

**Guard:** Jamie Escobar-Dyer

**Time and Penalty:** John Meyers

**Contest Director:** Joe Sipiora

**Associate Contest Director:** Gary Bartelt

**Announcer:** Roger Green



## 2023 Seminole Sound Spectacular Judges and Staff Hospitality

We have full service hospitality room.  
Sandwiches, chicken tenders, sides,  
desserts, drinks, coffee, and more

It's in the corner gym classroom,  
down the hall from the tennis courts.

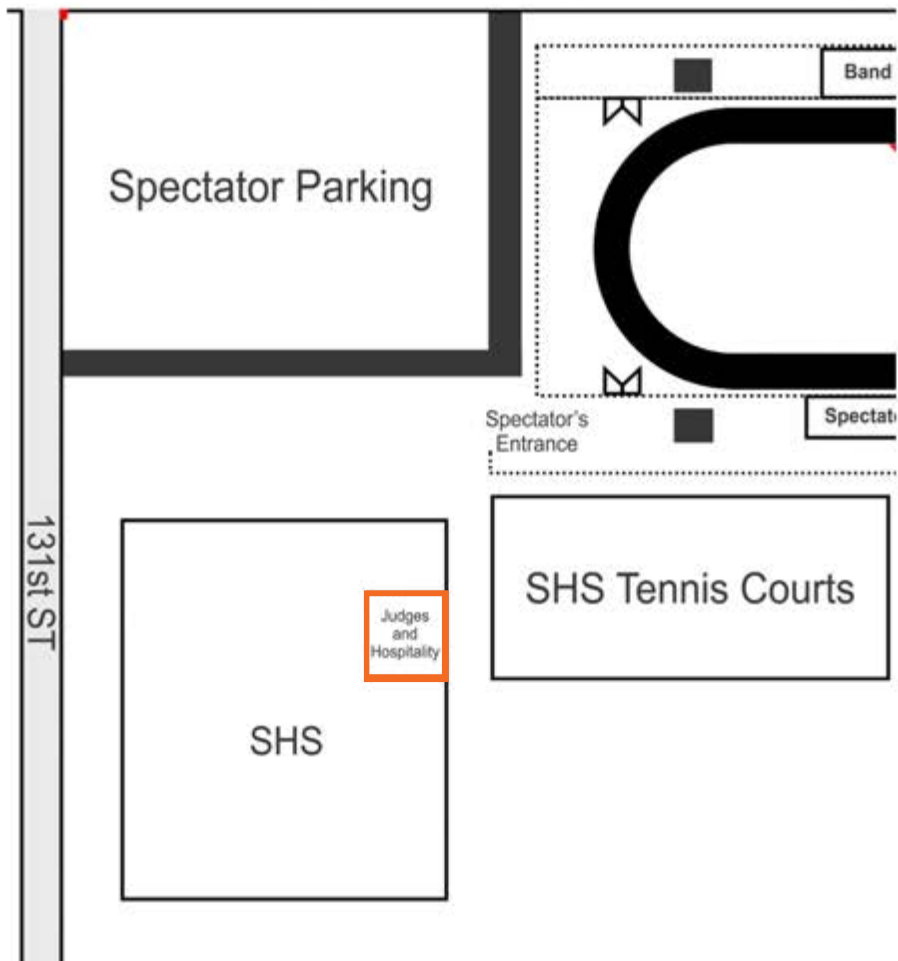





# 2023 Seminole Sound Spectacular Schedule

## Exhibition

Seminole Middle School ..... 2:45pm

## Exhibition

## Division 1A

Fivay High School ..... 3:00pm

Osceola Fundamental High School ..... 3:15pm

Dunedin High School ..... 3:30pm

## Division 1A

## 20min Break

Lecanto High School ..... 4:05pm

St. Petersburg High School ..... 4:20pm

Countryside High School ..... 4:35pm

Calvary Christian High School ..... 4:50pm

Largo High School ..... 5:05pm

Little Hawks Performance ..... **75min Dinner Break**

## Division 2A

Hollins High School ..... 6:35pm

F.W. Springstead High School ..... 6:50pm

Palm Harbor University High School ..... 7:05pm

Northside Christian School ..... 7:20pm

## Division 2A

## 20min Break

## Division 3A

East Lake High School ..... 7:55pm

Southeast High School ..... 8:10pm

Braden River High School ..... 8:25pm

## Division 3A

## 20min Break

## Division 4A

Venice High School ..... 9:00pm

George M. Steinbrenner High School ..... 9:15pm

## Division 4A

## Division 5A

Tarpon Springs ..... 9:30pm

## Division 5A

## Exhibition

Seminole Exhibition ..... 9:45pm



# 2023 Seminole Sound Spectacular Parking and Driving Instructions

**Spectator Parking** - will be located in front of the Seminole High School. There will only be one entry point on 131st street. Parking is free, donations are accepted.

**Bus and Staff Parking** - will be located at Tech High School. Please let the traffic volunteers know that you are staff of the band if you are traveling in a car. In order to park here, you must enter from 125th street. If you come from 131st, you will be asked to go around to 125th.

**Trucks and Trailer Parking** - will be located at Bauder Elementary. Please follow the directions of the traffic volunteers. You must enter from 125th and 86th.

**NO VEHICLES ARE PERMITTED THROUGH 86th AVE.** Pinellas County Sheriffs Requirements. Please do not come from 131st street with buses, trucks, or trailers. Only 125th street will you have access.

There is not any parking permitted on the west side of the Seminole High School Main Office. Please contact [specialevents@seminoleband.org](mailto:specialevents@seminoleband.org) if you have any questions or special needs for this occasion.

# SEMINOLE SOUND

## CONCESSION MENU

### - ENTREES -

		With Chips & Water	With Chips & Soda
<b>Hamburger</b> 1/3 lb Angus Beef	\$6	\$8	\$9
<b>Cheeseburger</b> 1/3 lb Angus Beef with America Cheese	\$7	\$9	\$10
<b>Fried Chicken Sandwich</b> Boneless fried chicken	\$7	\$9	\$10
<b>Hot Dog</b> 100% Beef	\$4	\$6	\$7
<b>Wally Wappa</b> 1/3 lb Angus Beef, American Cheese on a glazed donut	\$7	\$9	\$10
<b>Chicken Fingers</b> 3 pieces of white meat	\$7	\$9	\$10
<b>Pizza per slice</b> Hungry Howies pepperoni and cheese	\$3	\$5	\$6

### - SNACKS -

<b>Nachos and Cheese</b>	\$5
<b>French Fries</b>	\$4
<b>Mozzarella Sticks</b> 5 sticks served with ranch or pizza sauce	\$6
<b>Pretzel Oven Baked</b> Cinnamon or salted	\$4
<b>Chips</b>	\$1
<b>Cheese Only</b> Nacho	\$1

### - DESSERTS -

<b>Funnel Cake</b> Cinnamon or powdered sugar	\$7
<b>Cotton Candy</b>	\$3
<b>Candy</b>	\$2
<b>ICEE Freeze</b>	\$3

### - DRINKS -

<b>Water and Soda</b>	\$2
<b>Gatorade</b>	\$3

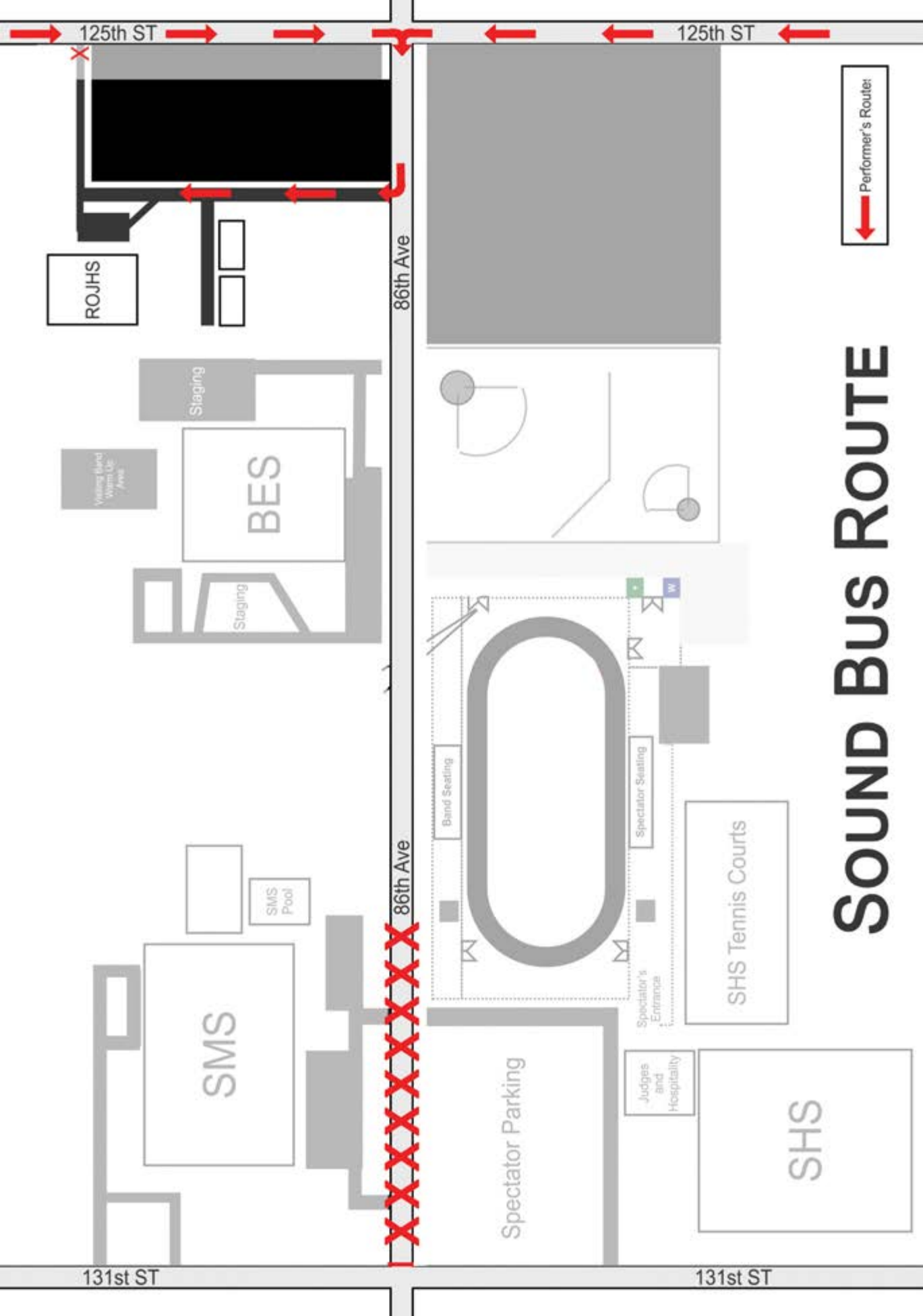

125th ST

125th ST

86th Ave

86th Ave

131st ST

131st ST

Performer's Router

# SOUND BUS ROUTE

ROJHS

Staging

Visiting Band Warm Up Area

BES

Staging

SMS Pool

SMS

Band Seating

Speciator's Entrance

Speciator Seating

SHS Tennis Courts

Speciator Parking

Judges and Hospitality

SHS



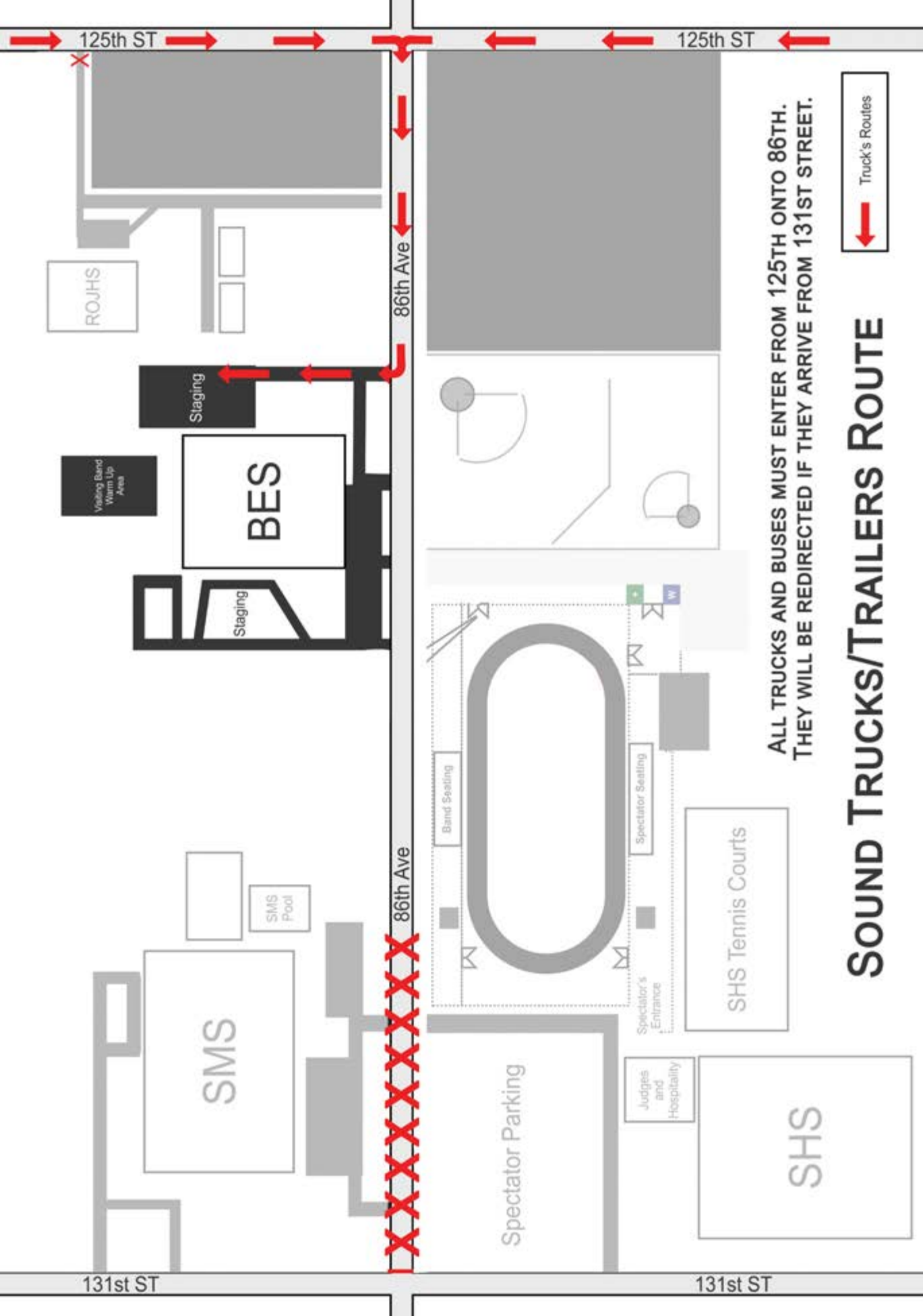

125th ST

125th ST

ROJHS

Staging

Visiting Band Warm Up Area

BES

Staging

SMS

SMS Pool

86th Ave

Band Seating

Spectator's Entrance

Spectator Seating

SHS Tennis Courts

Spectator Parking

Judges and Hospitality

SHS

131st ST

131st ST

ALL TRUCKS AND BUSES MUST ENTER FROM 125TH ONTO 86TH. THEY WILL BE REDIRECTED IF THEY ARRIVE FROM 131ST STREET.

# SOUND TRUCKS/TRAILERS ROUTE

Truck's Routes

125th ST

125th ST

Road Close

86th Ave

86th Ave

Road Close

131st ST

131st ST

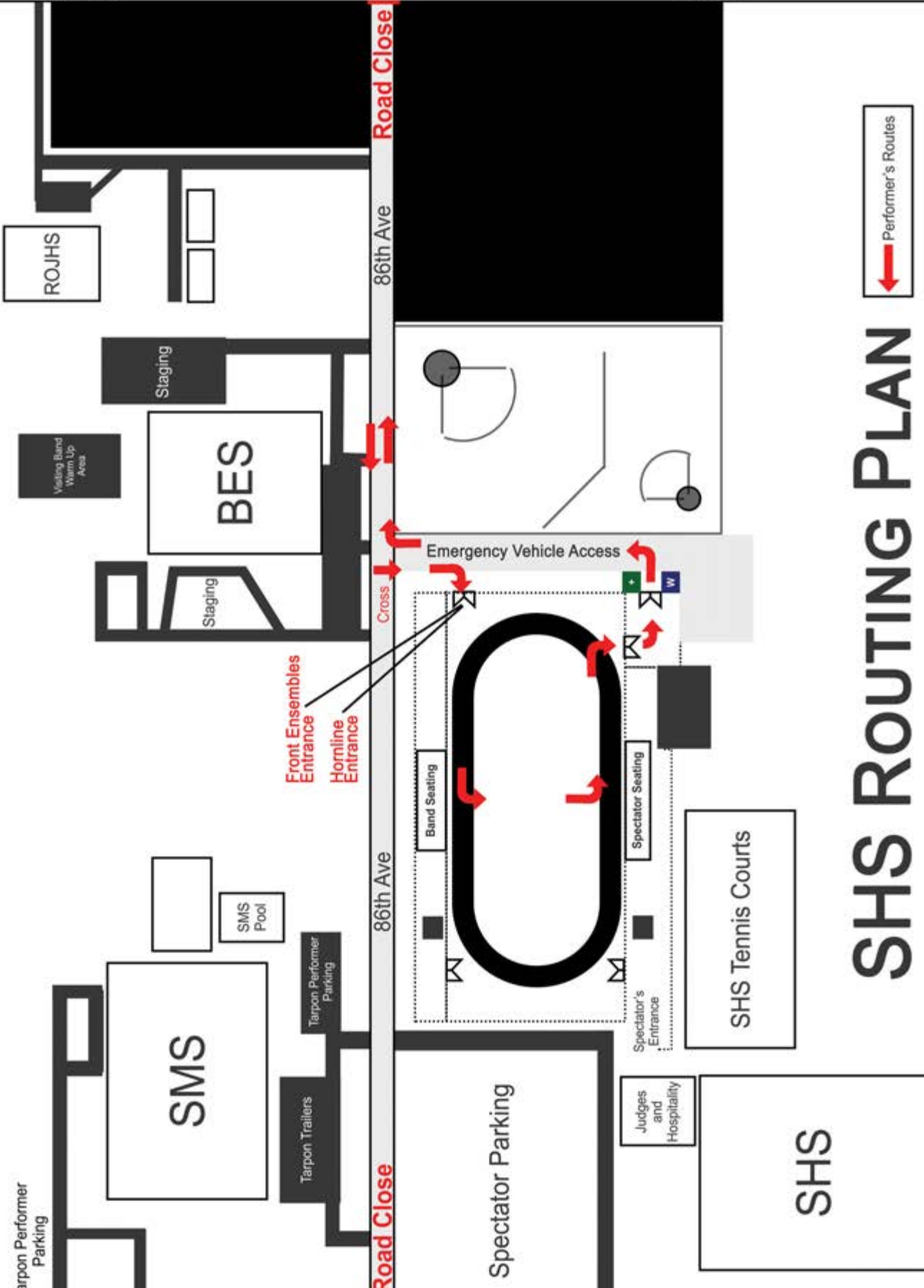

# SHS ROUTING PLAN

Performer's Routes

## **Seminole Sound Staging Instructions**

All equipment trucks and busses will enter at the intersection of 86th avenue and 125th street and proceed West onto 86 Ave towards bus parking.

All busses will be greeted at the entrance of Richard O Jacobson Technical Highschool and will be escorted inside to park.

Your band will be directed to Marching warmup area next door at Bauder Elementary.

Equipment trucks will continue West on 86th Ave to Bauder Elementary school and will be directed where to park and unload.

Front ensemble warmup will be at Bauder on the rear blacktop.

We will provide trailers/drivers to transport front ensemble equipment/kids to the stadium for their performance. As well as pick them up after their performance and return them back to Bauder to reload into their equipment trucks.

After reloading your equipment, your truck/trailer may be asked to relocated off campus in order to accommodate later arriving bands and equipment. (there will be reserved space along 86th Ave for overflow parking, which will afford a quick exit at the end of the night)

Props will have to be pushed to the stadium to the prop holding area from Bauder. Depending on foot traffic, larger props may be dropped off by vehicle and unloaded closer to prop holding area.

Please contact [specialevents@seminoleband.org](mailto:specialevents@seminoleband.org) if you have any questions or special needs for this occasion.

**SEMINOLE**  
**WARHAWK**  
**BAND**

Seminole Sound Ticket Presale

